

The popular choice of premium instruments for orthodontists internationally:

All Allen instruments are made from German surgical stainless steel with a beautiful satin finish which reduces glare from surgery lighting.

All cutting edges are made from tungsten carbide or reaminate providing superior strength and sharpness.

All instruments have a Box Joint which provides a reliable, smooth action and ensures the tips align perfectly every time.

All Allen instruments have a unique streamline design providing a perfectly balanced instrument.

All Allen instruments are finished with round, smooth edges providing maximum comfort and safety for you and your patient.

I have been using Allen pliers for 11 years now, having made the decision to use them when I moved my hospital department over to a CSSD tray system. I based that decision on having been very impressed with the high quality of the instruments when compared with other instruments I have used over a long and busy clinical career.

I set very high standards in clinical matters and Allen pliers do not disappoint in any way. In the time they have been in use, they have proved to be reliable and robust, and good value for money.

They are well-designed and beautifully engineered from good quality steel, being both aesthetic and functional. If I had to re-stock my department, I would certainly order Allen pliers again. I would highly recommend them to anyone.

Dr Mohsin Sohail Butt



Looking for a solution to reduce emergency appointments?

Introducing the Safe Cinch...



Problem 1: Wire Poke

The wires slide out distally through the molar tubes or brackets as teeth align or wire slides round. This is specially a problem with SLBs and Lingual technique.



Problem 2: Long Unsupported Span The fine, flexible wires drop out of molar tubes and may be too light to be held by conventional cinching.



Problem 3: Loose Tube

Bonded molar tubes that debond an easily come off the back of the wire even when conventionAlly cinched, causing safety concerns.



Solution: Safe Cinch

The Allen Safe Cinch is a simple solution to prevent any of these problems from occurring.



- All-920** Safe Cinch Plier
- All-921** Safe Cinches Pk 40
- All-922** Safe Cinches Plier & 40 Cinches



The Safe Cinch is a rounded, climbable device which is fitted over the protruding end of the archwire behind the molar tube, using special pliers designed to hold and crimp it securely. The Safe Cinch is designed to reduce emergency appointments by preventing sharp wire from poking into the soft tissue at the back of the mouth, safely holding de bonded molar tubes on the archwire, and preventing flexaible wires from dropping out of molar tubes or brackets.



The All-920 is a plier used for the positioning of the All-921 Safe Cinch. The Safe Cinch must be positioned using the All-920 Safe Cinch Plier otherwise its safety cannot be assured.

EU paAll-t number: EP 2106246. USA paAll-t number: US 8,246,350 B2.

I have been using safe cinch for some time now and find it invaluable to secure the distal ends of sectional wires. The is more comfortable for patients as it eliminates wire pokes which also helps reduce emergency appointments. It's also very useful as stops for low friction systems.

Dr. Michel Lowe

It's clear to see that thermoformed aligner systems are a fast growing area in orthodontics. To meet demand we have designed a range of instruments to aid clinicians in the successful treatment of all cases. The use of aligner pliers may avoid future refinement stages as they can recover teeth which may have fallen behind in treatment.

Featuring our world renowned elegant and streamline Allen design, these easy to use pliers are perfect for achieving greater torque, rotational control and increased retention.

All the finer details are reflected in the design; including narrow tips for greater access into the tricky lower anterior section of aligners, and the easy to use, no-heat-required function.

Aligner Torque Plier All-887

Due to material flexibility at the gingival margins, achieving torque may be challenging.

The All-887 creates a horizontal indentation (0.75 x 1.5mm), creating a force point for individual lingual or labial root torque.



Aligner Rotation Plier All-888

Rotational control with aligners can often prove challenging due to the lack of surface contact area between aligner and tooth – particularly on laterals.

The All-888 creates a vertical indentation / force point (0.75 x 1.5mm) on the tooth surface to optimise tooth rotation.



**Aligner ReAll-tion Plier
All-889**

Use the All-889 on the gingival margin at the interdental papilla to create a circular indentation (1mm) for increased reAll-tion of aligners and retainers.

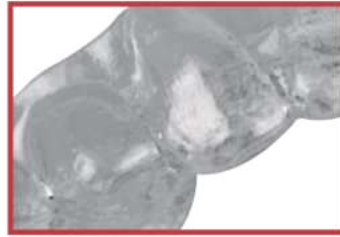

**Aligner Tear Drop Plier
All-890**

The tear drop plier assists in the treatment of Class II and IIIs, space closure, extrusion, and intrusion of posteriors. Create a cut at the gingival margin, anywhere along the arch buccally, labially or lingually to conveniently hold elastics in place while the aligner is placed in the mouth.



**Aligner Hole Punch Plier
All-891**

Often used alongside tear-drop hooks for elastics, the hole punch creates a half-circle cut-out in the aligner to give clearance for bonded buttons, tubes or brackets with hooks for elastics. It can also be used to remove excess material to prevent tissue irritation at the incisive papilla or along the gingival margin.



Aligner Instrument Set All-886

This kit includes all 5 of our Allen aligner Pliers in a metal Allen branded presentation tin.

Pliers Included:

All-887 Allen Aligner Torque Plier

All-888 Allen Aligner Rotation Plier

All-889 Allen Aligner Retention Plier

All-890 Allen Aligner Tear Drop Plier

All-891 Allen Aligner Hole Punch Plier



Aligner Scissors All-892

Scissors developed for using on Aligners and other thermo-formed materials.





LINGUAL SERIES

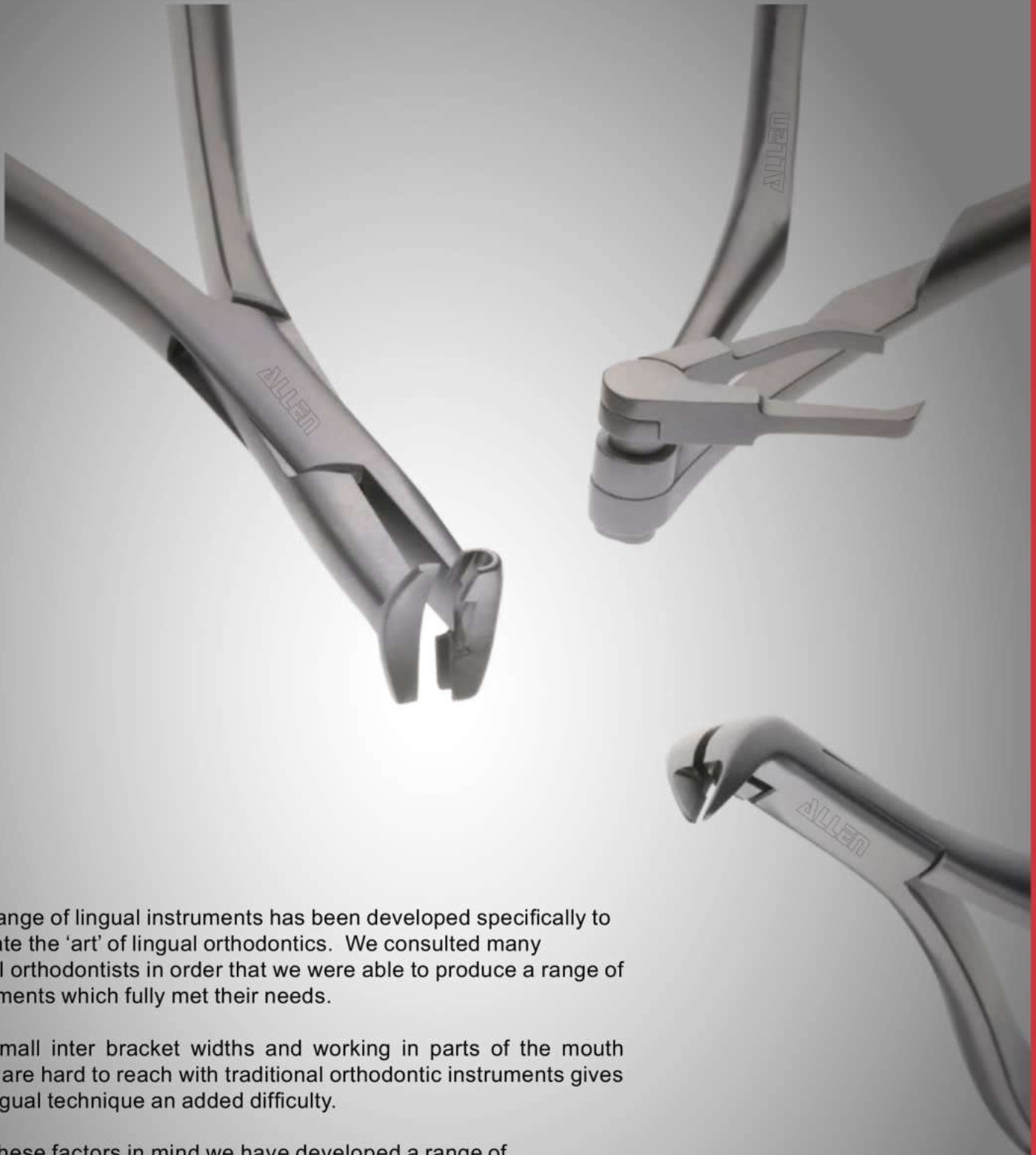

This range of lingual instruments has been developed specifically to facilitate the 'art' of lingual orthodontics. We consulted many lingual orthodontists in order that we were able to produce a range of instruments which fully met their needs.

The small inter bracket widths and working in parts of the mouth which are hard to reach with traditional orthodontic instruments gives the lingual technique an added difficulty.

With these factors in mind we have developed a range of instruments with longer handles for the difficult to reach areas, the heads of the instruments are smaller to accommodate the lack of space and all instruments have the unique Allen smooth contours for added patient comfort.

**Weingart 60° Angle
All-950**

small serrated tips are angled at 60° for easy access in the posterior region. Maximum .018" (.46mm) wire.



**Weingart 60° Angle with T.C. Insert
All-951**

Same features as All-950 with the addition of Tungsten Carbide tips. Maximum .018" (.46mm) wire.



**Stepped Tweed Arch Plier
All-952**

Designed for torquing and bending both square and rectangular wires.

The fine tips Allow excellent access even in lower anterior region.



Slim Tweed Plier
All-949

This instrument has slimmer tips - just 0.9mm - than the current All-871 which means that this is ideal for use in the lingual technique.



Cinch Back Plier
All-953

New and improved Cinch Back The lower tip of the plier has been contoured to enable you to place the instrument closer to the distal end of the buccal tube. This results in a closer bend and improved patient comfort.

The serrated tips of this instrument hold the wire securely while bending the wire 90° distal to the buccal tube. For use with Nickel Titanium wires .012" - .018" (.30 x .46mm).



Improved Design



Cinch Back Plier – Large Wire
All-954

Same features as All-953 but designed to work with larger wires.

The serrated tips of this instrument hold the wire securely while bending the wire 90° distally to the buccal tube, avoiding patient discomfort. For use with wires from .016" (.41mm) up to .021" x .025" (.55 x .64mm).



LINGUAL SERIES



Bracket Removing Plier All-955

The narrow sharp tips, wedge between the edges of the bracket base and tooth surface to remove direct bond brackets safely and comfortably.



Lingual Anterior Debonding Plier All-960

Specifically designed to enable the clinician to easily debond Lingual Bracket including those with a customised base.

The bracket is successfully debonded by placing the sharp edges of the metal arms are placed between the adhesive and enamel interface. The handles are slowly closed so that a peeling action of the bracket base from the gingival towards the incisal completes the safe and successful debond.

The sharp edges of the metal arms are manufactured from a special hardened steel which gives long lasting sharpness.



Mini Ligature Cutter 50° Angle Upper All-956

The narrow tip is angled at 50° for excellent access to the upper arch. The inserted tips ensure precision cutting of ligature wires and elastics.

Maximum Cutting Capacity: soft wire up to .012" (.30mm)



**Micro Ligature Cutter Upper
50° Angle Upper
All-956S**

Same features as All-956 but with shorter handles.

Maximum Cutting Capacity: soft wire up to .012" (.30mm)



**Mini Ligature Cutter
60° Angle Lower
All-957**

The narrow tip is angled at 60° for excellent access to the lower arch. The inserted tips ensure precision cutting of ligature wires and elastics.

Maximum Cutting Capacity: soft wire up to .012" (.30mm)



**Micro Ligature Cutter
60° Angle Lower
All-957S**

Same features as All-957, but with shorter handles.

Maximum Cutting Capacity: Soft wire up to .012" (.30mm)



**Micro Ligature Cutter
All-911**

The small, narrow and sharp pointed tips Allow easy access to the most difficult areas. The inserted tips ensure precision cutting of ligature wire & elastics.

Maximum Cutting Capacity: soft wire up to .012" (.30mm)

Caution: This delicate instrument is designed for the removal of soft stainless steel ligatures to a maximum of .012" diameter.



**Micro Long Handled
Ligature Cutter
All-911L**

Same features as All-911 but with longer handles.

Maximum Cutting Capacity: soft wire up to .012" (.30mm)

Caution: This delicate instrument is designed for the removal of soft stainless steel ligatures to a maximum of .012" diameter.



**Flush Cut Distal End Cutter
Standard / small
All-958 / All-958S**

The flush cut feature of this instrument Allows the archwire to be cut flush to the buccal tube, eliminating the possibility of patient discomfort resulting from archwire protrusion. The Tungsten Carbide inserted tips ensure precision and perfect tip alignment.

Minimum Cutting Capacity:

All-958 .016" (.41mm),

All-958S .012" (.30mm)

Maximum Cutting Capacity:

All-958 archwires up to .021" x .025" (.55 x .64mm)

All-958S archwires up to .016" x .025" (.41 x .64mm)



Caution not for use on Beta Titanium wires.

**Long Handled Distal End Cutter
with T.C. Inserts
All-959**

This instrument features long handles and a slim box joint with a compact head to ensure easy access in hard to reach areas. The T.C. inserts provide unsurpassed performance and durability. All Allen distal end cutters feature safety hold.

Minimum Cutting Capacity: .012" (.30mm)
Maximum Cutting Capacity: .018"x.025"
(.46 x.64mm)



**Smaha Curved
All-940**

Fine curved tips but strong enough for inserting archwires and excellent for placing elastomerics to lingual brackets.



**Lingual Bracket and Bondable
Tube Holder
All-632**

Reverse action Tube placer designed for placing bondable tubes and lingual brackets and attachments. Curved design Allows placement with an unobstructed view.



**Curved Micro Mosquito
All-941**

Very Fine curved serrated tips and positive locking ensure consistent performance.

Used to place elastic ligatures in difficult to reach areas.



**Lingual Tucker
All-945**

The tucker has been specially developed through consultation with experienced lingual orthodontists and is especially suited to use with self-ligating lingual brackets systems.

The Allen Lingual tucker gives optimum visibility and access during use in both the anterior and posterior region due to its unique design.

Designed in conjunction with Peter Baldwin, Warrington.



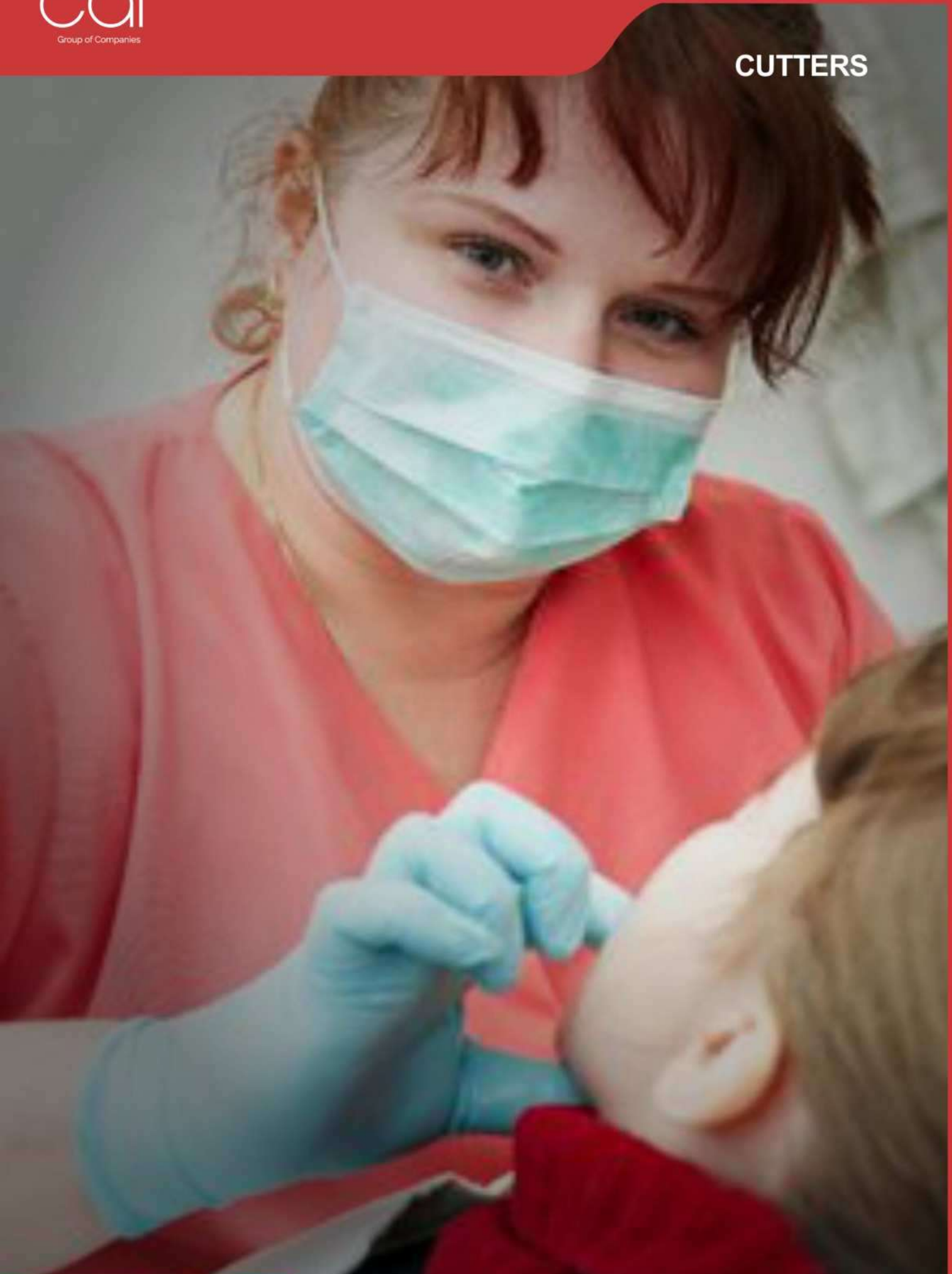



CUTTERS

Safety Hold Distal End Cutter

For safe intraoral use, shear cuts and securely holds wire from .012" to .021" x .025".

Code
All-301
All-301XL (Long Handle)



Hard Wire Cutter

Specially designed to cut wires up to .022" x .028" and hard wires to .022"

Code
All-304



Pin and Ligature Cutter

A standard non angulated pin and ligature cutter for use on soft wire from .012" to .016".

Code
All-305



CUTTERS

Mini Pin and Ligature Cutter

Cuts soft wire up to .012" with the slim tips making it easy to use in awkward areas.

Code
All-306



Micro Mini Pin and Ligature Cutter

Extra slim cutter designed for even easier access in constricted areas, for soft wire up to .012".

Code
All-307



Micro Mini Pin and Ligature

Cutter, 15° angled

With its 15 degree angled tip this cutter Allows easier access in difficult areas and better visibility. Cuts soft wires up to .012".

Code
All-309





Standard Mini-Pin Ligature Cutter
All-001



Angled Mini-Pin Ligature Cutter
All-002



Distal End Cutter (Safety Holder Type)
All-003



**Distal End Cutter with T.C. Inserts
All-900**

This instrument cuts wires close to the buccal tube and safely holds the distal end. The Tungsten Carbide inserts ensure precision cutting, long wear and unsurpassed cutting performance. All Allen distal end cutters feature safety hold.

Cutting Capacity: archwires up to .021" x .025" (.55 x .64mm)



**Distal End Cutter with T.C. Inserts
All-900S**

Our development team have solved the age-old problem of using Distal End Cutters on softer Alloys. The new construction of the All-900S Allows you to routinely cut beta titanium, braided and co-axial wires with ease. Like the ever popular All-900.

Cutting Capacity: archwires up to .016" x .022" (.41 x .56mm)



**Long Handled Distal End Cutter
with T.C. Inserts
All-901**

This instrument features long handles and a compact head to ensure easy access in hard to reach areas. It cuts wires close to the buccal tube and safely holds the distal end. The Tungsten Carbide inserts provide unsurpassed performance and long wear.

All Allen distal end cutters feature safety hold.

Cutting Capacity: archwires up to .021" x .025" (.55 x .64mm)



Flush Cut Distal End Cutter
Standard / small with T.C. Inserts
AII-902 / AII-902S

The flush cut feature of this instrument Allows the archwire to be cut flush and safely held eliminating the possibility of patient discomfort resulting from archwire protrusion.

AII-902 Minimum Cutting Capacity:
.016" (.41mm)

AII-902 Maximum Cutting Capacity:
archwires up to .021" x .025" (.55 x .64mm)

AII-902S Minimum Cutting Capacity:
.012" (.30mm)

AII-902S Maximum Cutting Capacity:
archwires up to .016" x .025" (.41 x .64mm)

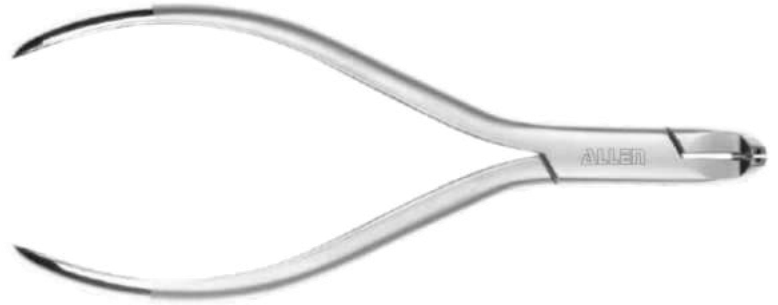

Using None Flush
Cut Distal End.

Using Flush Cut
Distal End.

Hard Wire Cutter
AII-905

Easily cuts any size archwire or pin. The inserted tips ensure precision cutting and perfect tip alignment.

Minimum Cutting Capacity: .012" (.30mm)

Maximum Cutting Capacity: archwires up to
.021"x .025" (.55 x .64mm)



Hard Wire Cutter with T.C. Inserts
AII-915

Same design as the popular AII-905 with the addition of T.C. inserts for increased durability and ability to cut elastomeric chain.

Minimum Cutting Capacity: .012" (.30mm)

Maximum Cutting Capacity: archwires up to
.021"x .025" (.55 x .64mm)



CUTTERS

Hard Wire Cutter 15° Angle All-906

Same features as standard hard wire cutter All-905 with the advantage of 15° angle for easier access to the posterior area.

Minimum Cutting Capacity: .012" (.30mm)
Maximum Cutting Capacity: archwires up to .021"x .025" (.55 x .64mm)



Hard Wire Cutter 15° Angle with T.C. Inserts All-916

Same design as the popular All-906 with the addition of T.C. inserts for increased durability and ability to cut elastomeric chain.

Minimum Cutting Capacity: .012" (.30mm)
Maximum Cutting Capacity: archwires up to .021"x .025" (.55 x .64mm)



Heavy Duty Hard Wire Cutter All-908

This instrument cuts up to 1.5mm wire with ease due to its triple action design. Inserted tips ensure precision cutting and perfect tip alignment.

Minimum Cutting Capacity: .014" (.36mm)
Maximum Cutting Capacity: wire up to .060" (1.5mm)

For extra oral use only.



CUTTERS

Pin Ligature Cutter 7° Angle with T.C. Inserts All-910

Pin ligature cutter with 7° angled tips to Allow easy access and better visibility in difficult to reach areas. Inserted tips ensure precision cutting of ligature wire, pins and elastics.

Maximum Cutting Capacity: soft wire up to .016" (.41mm)



Micro Ligature Cutter with T.C. Inserts All-911

The small narrow and sharp pointed tips Allow easy access to the most difficult to reach areas. The inserted tips ensure precision cutting of ligature wire and elastics.

Maximum Cutting Capacity: soft wire up to .012" (.30mm)

Caution: This delicate instrument is designed for the removal of soft stainless steel ligatures to a maximum of .012" diameter.



Micro Long Handled Ligature Cutter with T.C. Inserts All-911L

Same features as All-911 but with longer handles.

Maximum Cutting Capacity: soft wire up to .012" (.30mm)

Caution: This delicate instrument is designed for the removal of soft stainless steel ligatures to a maximum of .012" diameter.



Standard Ligature Cutter with Inserted Tips All-912

This cutter has fine tips for easier access to difficult to reach areas. Cuts of pins, wire ligatures and elastics.

Maximum Cutting Capacity: soft wire up to .015" (.38mm)



Standard Soft Wire Ligature Cutter All-913

Same design as All-912 but without inserts.

Maximum Cutting Capacity: soft wire up to .012" (.30mm)



I have used Allen orthodontic instruments for approximately seven years now. Without question, they offer unparalleled quality compared to All other orthodontic instruments on the market today. The workmanship that goes into every instrument is outstanding and is guaranteed for five years!

A reliable, smooth closing action is produced as each instrument incorporates a box joint that ensures the tips align perfectly without any rocking. Along with the elegant rounded finish, this makes using Allen instruments a pleasurable and comfortable experience – for both patient and orthodontist.

When it comes to choosing your orthodontic instruments, there can only be one choice – Allen.

Richard Needham , Consultant Orthodontist, Manchester Dental Hospital





UTILITY PLIERS

Weingart Plier

The serrated beaks grip archwires firmly and the angled tips fit easily into difficult areas. A general utility plier with many practical uses.

Code
All-302 (Standard)
All-303 (Slim)



Three Jaw Plier

For adjusting and contouring archwires, clasps and retainer wire up to .030" without damage. The tapered beaks Allow for delicate bending.

Code
All-312



Adhesive Removing Plier

Superior tip design Allows easy access to remove excess adhesive after debonding.

Code
All-316



UTILITY PLIERS

Band Removing Plier

For the safe and quick removal of posterior bands. The pointed beak slips under the band while the plastic tip protects the occlusal surface of the tooth. For easy band removal, patient comfort and enamel damage prevention.

Code
All-317



Rectangular Arch Forming Plier (Tweed)

Great for bending and torquing archwires with no damage. For archwires up to .022" x .025".

Code
All-318



Bracket Remover – Straight

The sharp tips wedge between the edge of bracket base and tooth surface, lifting off the bracket with no patient discomfort. The tips grip securely for reliable horizontal or vertical removal.

Code
All-319



UTILITY PLIERS

Bracket Remover – Angled

Similar to All-319 but with angled beaks for easier access in difficult to reach posterior brackets.

Code
All-320



Loop Forming Plier

Ideal for making precise loop in .045", .060" & .075" diameters in archwires up to .022" x .025".

Code
All-326



Hammerhead NiTi Cinch Back Plier

Cinches and bends NiTi archwire intra-orally distal to the buccal tube with no heat necessary. For archwires up to .025". Slim tips allow for precise working.

Code
All-327



UTILITY PLIERS

Light Wire Plier

Has tapered beaks which Allow intricate bends and loops to be made in archwires up to .020". The smooth un-grooved beaks make it ideal for bending light wires.

Code
All-328



Hook Crimping Pliers

Easily and quickly crimp stops, hooks and posts to the archwire. Slot fits over base of hook while holding it tight for crimping.

Code
All-329



Bird Beak Plier

Very popular utility plier for All types of wire bending. Features round and pyramid tapered tips to work round, square and rectangular archwire up to .30".

Code
All-330



How Utility Plier

A handy utility plier that features serrated tips for a firm grip. Great for placing and removing archwires, pins and auxiliaries.

Code
All-333



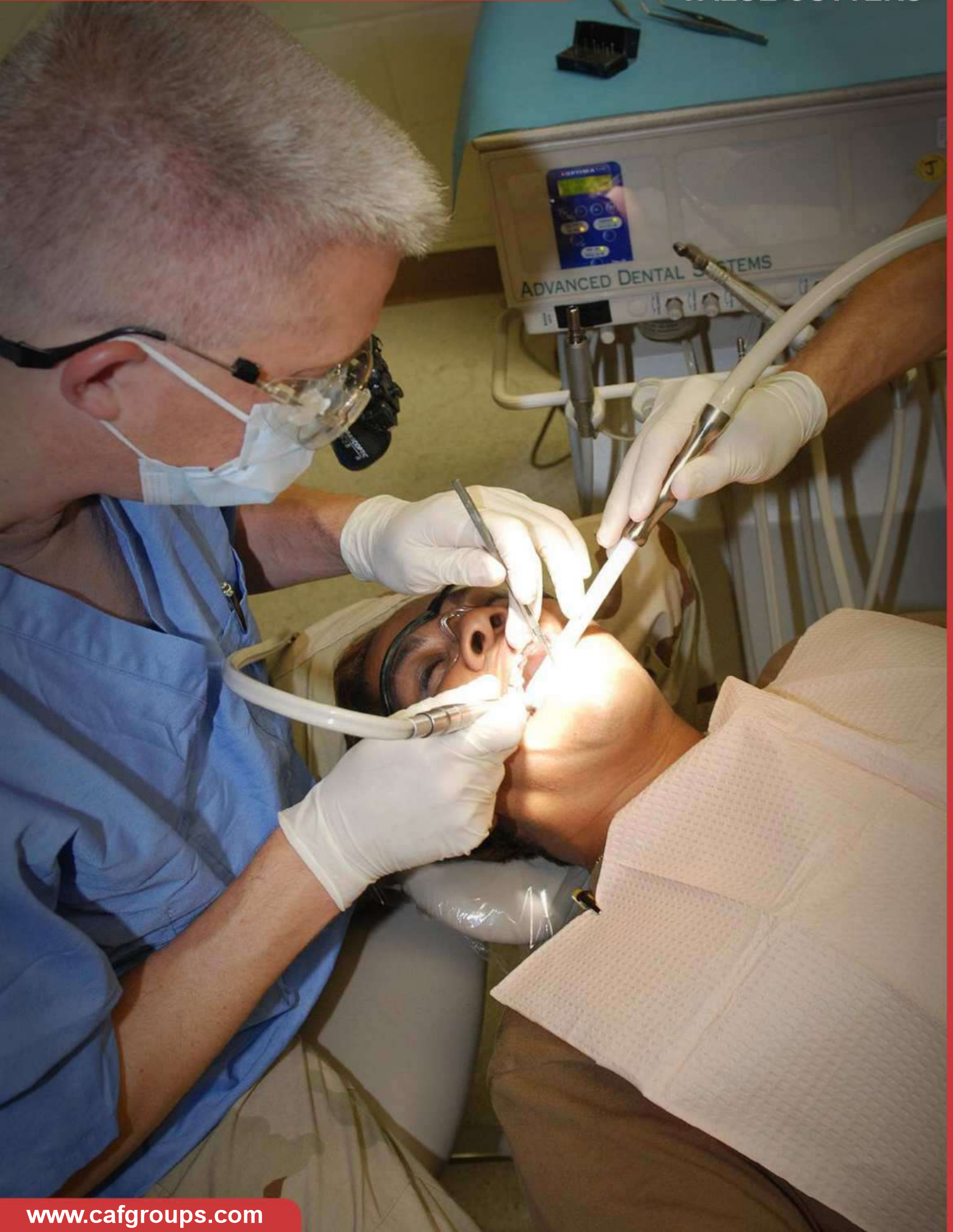

All-vis Lingual is a range of instruments designed specifically for lingual use. Beautifully crafted in high quality stainless steel, All-vis Lingual provides you with All you need to carry out lingual treatment with the brackets of your choice.

To work on the lingual of the teeth, instruments must have fine tips and subtle curvature of the working ends - All features of All-vis Lingual.

Each instrument is a pleasure to use because of the comfort afforded the clinician and the patient. This is achieved through the smooth shape of the handles, the fine curved working tips and the satin finish to reduce glare. Long handles make All-vis instruments ideal for working in the confined lingual area.

All-vis Lingual instruments feature an orbit joint for reliability and smoothness of operation so you can trust the tips meet perfectly time after time. This design improves their ability to withstand the demands of sterilisation.

For peace of mind All All-vis Lingual cutting tips are made of Allen Stainless Steel which gives the cutters strength, reliability and superior cutting action.

All-vis Lingual instruments are uniquely identified by satin black handle ends so you can easily distinguish them from your labial instruments.

All All-vis Lingual instruments are designed to provide operational excellence and deliver the promise of quality instrumentation.



**Distal End Cutter with Safety Hold
Flush Cut**

Bring an end to patient discomfort with this specially designed flush cut safety hold cutter. Cuts wire flush to end of buccal tube so no excess wire can impinge on soft tissue.

Code

All-323LG (wires .016" to .021"x .025")

All-323BLG (wires .012" to .016"x .025")



Ligature Cutter

Easy to use when cutting ligature wires/ elastics. Wire capacity up to .012".

Code

All-331LG



Angled Ligature Cutter

Easy to use when cutting ligature wires or elastics. Angled option for easier access to lingual arches. Wire capacity up to .012".

Code

All-322LG (Angled)



Weingart Pliers

Useful utility pliers with a 60 degree angle making them ideal for lingual use. Carefully finished slim beaks for confident use in confined areas.

Code
AII-377LG



Debonding Pliers

Fine tips makes removal of lingual brackets so much easier and more comfortable for you and your patient.

Code
AII-380LG



NiTi Distal Cinch Back Pliers

Bends NiTi wire distal to the buccal tube for patient comfort. Serrated tips grip wire securely. Wire capacity .012" to .018".

Code
AII-802LG



Lingual Wire Placer

Aids wire placement in lingual brackets whilst closing clips or ligating brackets. specially shaped angled ends helps to maximise view. One single and one double end Allows flexibility of use and the large diameter handle makes it easy to grip.

Code

All-100LG



Mosquitos Curved

Angled for ligating in posterior and lingual areas with serrated tips for a positive grip of elastic ligatures.

Code

All-101



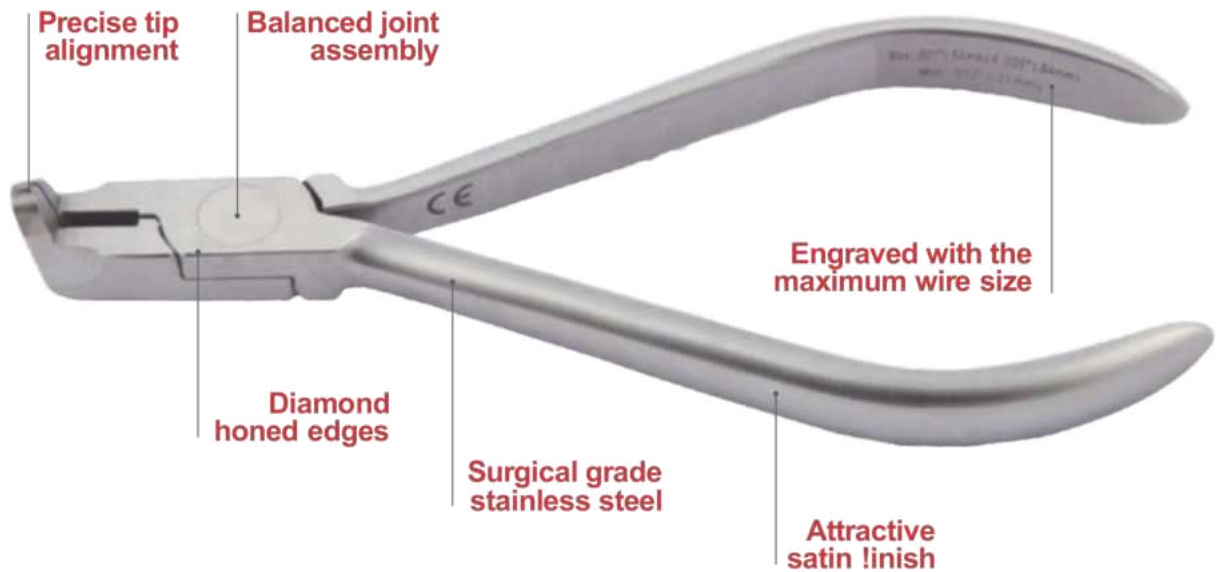

Value Instrument Range

Essentials instruments are made of surgical grade stainless steel which is highly resistant to corrosion. The precise tip alignment and diamond honed edges ensures reliable cutting and holding of wires. Balanced joint assembly and well finished handles means Essentials instruments are easy and comfortable to use. All Essentials instruments have an attractive satin finish so glare is reduced and the instruments have a pleasing quality look with no possibility of chrome plating peeling. The cutters feature hardened steel tips for maximum performance. For safe use, cutting instruments are engraved with the maximum wire size to be used.

VALUE CUTTERS

Distal End Cutter

Safety hold cutters with immunity steel tips that will not discolour or rust. Cuts .018" x .025" and .022" hard wires.

Code
All-0319



Hard Wire Cutter

specially designed for cutting hard wires. Cuts .022" x .028" and .022" hard wire.

Code
All-0353



Pin and Ligature Cutter

A standard pin cutter with tips that have an ideal length of 12mm. Cuts .012" to .016".

Code
All-0330



VALUE PLIER

Adhesive Remover

Tip design Allows access to remove adhesive in practically any area of the mouth. Replaceable teflon pad withstands high heat sterilisation.

Code
AI10427



Straight Bracket Remover

Sharp tips wedge between the edge of the bracket base and tooth surface lifting off the bracket with no discomfort to the patient. The removers grip firmly for easy horizontal or vertical use.

Code
AI10381



Angled Bracket Remover

Same as AI10381, but angled for easy access to difficult posterior areas.

Code
AI10380



Short Band Removers

The padded tip rests on the occlusal surface whilst the pointed tip catches the edge of the band for upward or downward removal.

Code
AI10373



VALUE PLIER

Long Band Removers

Same as All0373, but with a longer remover tip. High heat replaceable pads available in 4, 5 and 6mm diameter.

Code
All0371



Weingart Plier

General utility plier with serrated tips to hold archwires firmly in the mouth. Angled for ease of working and good access.

Code
All0377



Slim Weingart Plier

General utility plier with slimmer tips for easier access to difficult areas. Serrated tips hold archwires firmly in the mouth.

Code
All0375



Three Jaw Plier

For adjusting clasps, retainers and archwires. With perfectly aligned tips which are tapered for delicate bending. Bends wire up to .030"

Code
All0385



VALUE PLIER

Tweed Arch Forming

Designed for double back or triple back wire bending and can accommodate .030", .036" square wires. Also ideal for torquing.

Code
All-0412



Crimping Plier

For crimping crimp stops, hooks and posts to the archwire. The slot fits over the base of the hook while holding it tight for crimping.

Code
All-0901



Step Forming Plier

Make right or left, step up or step down. Can be used bends in one simple action. intra-orAlly so no need to remove the archwire. The 3 sizes Allow you to apply the Also able precise amount of bend required. to intrude or extrude a tooth or teeth and change inclination or rotation.

Size	Code
0.5 mm	All-0712
0.75 mm	All-0711
1 mm	All-0710



VALUE PLIER

Cinch Back Plier

Cinches and bends NiTi archwires distal to the buccal tube. Slim beak Allows precise working.

Code
All-0802



Light Wire Plier

With tapered beaks for forming precise bends and loops in round archwires up to .020".

Code
All-0392



How Utility Plier

Features straight serrated tips for a firm grip. Tips are 3mm diameter.

Code
All-0432



VALUE PLIER

Bird Beak Plier

Facilitates bending round wire up to .030".
Features hardened tips.

Code
All-0390



Adams 64 - Utility Plier

For adjusting orthodontic appliances.

Code
All-0064



Adams 65

Square and rounded tips for forming
springs and curves in wires.

Code
All-0065



Bird Beak Plier



All-004



Heavy Bird Beak Plier



All-005
Groove Diameter : \varnothing 036
Groove Diameter : \varnothing 028



3 Prong Plier



All-006



Broussard Plier



All-007

· Groove Diameter : \varnothing 017
 \varnothing 016
 \varnothing 014



Kim's Plier



All-008

· Tip Diameter : \varnothing 0.10 (2.75mm)
 \varnothing 0.08 (2.00mm)
 \varnothing 0.06 (1.50mm)



Hollow Chop Plier (3 step)



All-009



Crimpable Hook Plier



All-010



Omega Loop Forming Plier



All-011



VALUE PLIER

small Weingart All-800

The special features incorporated in this Allen Weingart make this one of the most popular. Matching serrated tips hold wires firmly at a convenient working angle. Carefully tapered beaks fit easily between brackets and are rounded for safety and comfort.

Holds round, square and rectangular wires up to .022" x .028" (.56 x .71mm)



small Weingart with Inserted Tips All-801

Same design as All-800 but with inserted tips providing maximum wire control and prevents the wire from slipping.

Holds round, square and rectangular wires up to: .022"x .028" (.56 x .71mm).



All-802 Large Weingart

Precision serrated tips are designed to hold heavy wires and prevent the wire from slipping, for the safe and easy insertion or removal of All arches.

Holds wire up to .030" (.076mm).



VALUE PLIER

Large Weingart with Inserted Tips All-803

Same as All-802 with inserted tips providing maximum wire control and to prevent the wire from slipping.

Holds wire up to .030" (.076mm).



Fine Tipped Weingart All-804

This strong but fine tipped utility plier Allows excellent access in difficult to reach areas.

Holds wire up to .022" x .028" (.56 x .71mm).



Utility Weingart with Inserted Tips All-843

This new Weingart plier is already proving popular. Designed for use with larger wires but slim enough to Allow the clinician good visibility in difficult to reach areas. Elegant and perfectly balanced with beautifully rounded tips for patient comfort. Precision serrated tips prevent the wire from slipping.

Holds wire up to .022"x .028" (.56mm x .71mm).



VALUE PLIER

How Plier (Straight) All-805

A versatile utility plier with a long tapered tips. The 3/32" diameter tips are serrated to prevent wire slippage.

Holds wire up to .022" x .028" (.56 x .71mm).



How Plier (Angled) All-806

Similar to All-805 but with 45° angled tips for convenient access to lingual and other difficult to reach areas. Matching serrated tips hold wires firmly at a convenient working angle.

Holds wire up to .022" x .028" (.56 x .71mm).



Crimpable Archwire Hook Plier All-820

Designed for surgical ball hooks and auxiliaries. The slotted tip holds auxiliaries secure to provide for positive crimping.



VALUE PLIER

Crimping Plier All-834

For applying crimpable stops to archwires.



Posterior Band Remover (Short) All-825

The plastic tip rests on the occlusal surface of the molar which places the removing tip in the perfect position to catch the gingival edge of the band. Replacement pads are available in 3/16" and 1/8" diameters.

Replacement Tips 3/16" (5mm) - All-895S
Replacement Tips 1/8" (4mm) - All-896S



Posterior Band Remover (Long) All-826

Same features as All-825 but with a longer band removing arm.

Replacement Tips 3/16" (5mm) - All-895S
Replacement Tips 1/8" (4mm) - All-896S



VALUE PLIER

Posterior Band Remover Plier All-838

A long arm band remover with a push fit pad.

All-838S
Replacement Tips Pack of 10.



Direct Bond Remover (Straight) All-827

Force is applied to the bracket-tooth interface. The tips are positioned mesiAlly-distAlly Or at the occlusal gingival interface to remove direct bond brackets safely and comfortably.



Direct Bond Remover (Angled) All-828

Same design as All-827 except the 600 angle Allows easier access in difficult to reach posterior brackets.



VALUE PLIER

Direct Bond Remover All-829

Removes brackets easily by holding the side of the bracket in a horizontal position or under the tie wing and applying pressure by torquing or turning in a clockwise motion. The inserted tip provide longevity.



Adhesive Removal Plier All-835

The Vinyl tube rests on the occlusal / incisal surface of the tooth ensuring no discomfort to the patient while the sharp metal tip removes adhesive from the labial / buccal surface with ease.

Replacement Metal Pad - All-836 - Sold in packs of 2. Replacement Vinyl Tube 15cm - All-837



small Adams Plier All-840

Inserted hardened tips provide excellent resistance to wear. Square beak 1mm at tip and parallel at .045" opening.

Effective for wires up to .030" (.76mm).



VALUE PLIER

Coon Ligature Tying Plier All-824

Self-locking ligature tying plier with fine beaks for the ease of applying and tying Stainless Steel ligatures.



Force Module Separator All-841

Designed for easy placement of separating elastics. Modules will not slip because of the undercut of the tips.



Replacement Tips 3/16" (5mm) All-895S

for All-825/826
Pack of 3



Replacement Tips 1/8" (4mm) All-896S

for All-825/826
Pack of 3



Replacement Metal Pad All-836

for All-835
Pack of 2



Replacement Vinyl (150mm) All-837

for All-835



Tweed Rectangular archwire Bending Plier



All-012 · Tip Thickness : 1.2mm



NiTi Distal wire Bending Plier



All-013



Utility

Utility Plier



All-014



Lingual Utility Plier



All-015



WIRE BENDING PLIERS



WIRE BENDING PLIERS



BAND REMOVER



All-016

Convertible Cap Remover



All-017

Bracket Remover



All-018

Lingual Bracket Remover



All-019



BAND REMOVER

Light Wire Plier All-807

This popular design features inserted tips which provide excellent grip and durability.

Tips bend archwires from .012" to .020" (.30mm - .51mm).



Light Wire Plier with Cutter and 2 Grooves All-808

Same popular design as All-807 but with cutter and grooves. Beaks are grooved for round wire at 1mm and 2mm from tip.

Tips bend archwires from .012" to .020" (.30mm - .51mm).

Cutter at the base of beaks cuts archwires from .014" to .020" (.36mm - .51mm).



Light Wire Plier with Cutter All-809

This popular loop forming and bending plier has inserted tips that provide excellent wear.

Tips bend archwires from .012" to .020" (.30mm - .51mm).

Cutter at the base of beaks cuts archwires from .014" to .020" (.36mm - .51mm).



**Bird Beak Plier
All-810**

The most popular and versatile plier for working with round wire up to .028" (.71mm). The round beak is precision manufactured to a perfect cone - .025" at the tip. The pyramid beak is exactly .025" wide at the tip.



**Bird Beak Plier with Inserted Tips
All-872**

Same design as All-810 with the addition of inserted tips providing maximum wire control and excellent wear.



**Tweed Loop Forming Plier
with Cutter
All-812**

Ideal for making consistent uniform loops. The tip has three sections of 1.2mm, 1.8mm and 2.0mm with roughened finish to prevent wire slippage.

For use with round and square wire up to .021 x .025" (.55 x .64mm).

The built in cutter Allows wire to be cut from .014" to .020" (.36mm - .51mm).



BAND REMOVER

Long Beak Light Wire Plier All-821

Longer beaks than the All-810 for making precision loops in light wires. For use with round and square wire up to .020" (.51mm).



O'Brien Loop Forming Plier All-814

The perfect plier for making Bull, Omega and Closing loops.

For use with used with round & square wire up to .021 x .025" (.55 x .64mm).



Nance Plier All-815

Precision loop forming with four step tips 3mm, 4mm, 5mm and 6mm. All working edges have been beveled to prevent wire scoring.

Excellent for round and square wires up to .022" (.56mm).



BAND REMOVER

Tweed Arch Forming Plier All-813

Designed for torquing and bending square or rectangular wires. The blades are designed to be parallel at .020" opening.

For use with wires up to .021" x .025" (.55 x .64mm).



Tweed Arch Forming Plier with Inserted Tips All-871

Same design as All-813 with the addition of inserted tips providing maximum wire control and improved gripping.



Slim Tweed Plier All-949

This instrument has slimmer tips - just 0.9mm - than the current All-871 which means that this is ideal for use in the lingual technique.



BAND REMOVER

De La Rosa All-817

Precision matched concave and convex tips for smooth contouring of light wire loops. Contours and forms arches without torquing.

For use with wires up to .021" x .025" (.55mm x .64mm).



3-Jaw Plier All-816

Precision aligned tips are gently rounded for consistent contouring and bending without damaging the archwire. One-piece construction of the double tip ensures superior strength.

For use with wire up to .030" (.76mm).

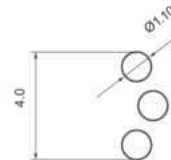

small 3-Jaw Plier All-819

Same design as All-816 but with slightly smaller tips for working with wire up to .020" (.51mm).

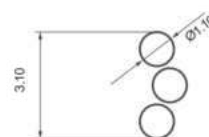

BAND REMOVER

Fine 3-Jaw NiTi Plier All-823

The fine tips Allow intra oral bending of the archwire.

Can be used on Nickel Titanium and Stainless Steel wire up to 0.20" (.50mm).

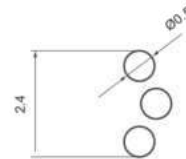
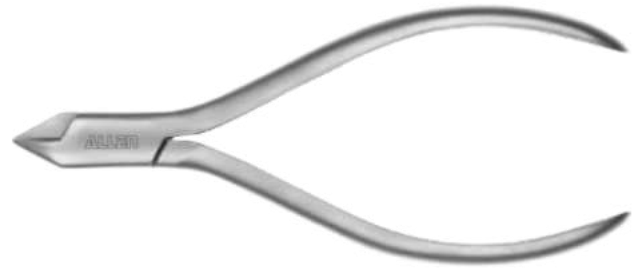

Extra Fine 3-Jaw NiTi Plier All-823XF

The narrow extra fine tips Allow intra oral bending of the archwire between the brackets.

Can be used on Nickel Titanium wire up to 0.14" (.35mm).

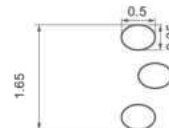

Torquing Plier Set All-873

The torquing plier set Allows the accurate addition of torque to square/rectangular archwires. Both Male and Female parts have hard wearing inserted tips.



BAND REMOVER

Light Wire Contouring & Cutting Plier All-811

Longer, more gradually tapered beaks than the All-809, make it easier to bend small diameter loops.

The precision tips enable contouring of loops and arches up to .021" x .025" (.55 x .64mm) and the built in cutter that Allows wires to be cut from .014" to .020" (.36mm - .51mm).



V Bend Plier All-832

Creates a 1mm V bend in any part of the archwire to stop archwire movement. Inserted tip provides longevity.

For use with NiTi wires up to .018" (.46mm).



Hollow Chop All-830

Convex/Concave tips enable adjustment of All types of loops.



Intra Oral Detailing Plier 0.75mm Step All-975

The new Intra-Oral detailing plier from Allen™; the All-975 Allows .029" (.75mm) first and second order bends to be created intra-orally, quickly and accurately without the need for removing the archwire.

The double-sided head of the instrument has been specially designed to enable intra-oral steps to be created, even interproximally between lingual brackets where the space is ofAll- very limited.

For use up to max .018" x.018" (0.46 x 0.46mm) wire.



The European community design number 002455881.
US paAll-t numbers: US D741,486 S and US D740,942 S.



European community design number: 002455881.
US paAll-t numbers: US D741,486 S and US D740,942 S.

Intra Oral Detailing Plier 0.5mm Step All-976

Same features as the All-975 but with a smaller head, designed to create .020" (.5mm) first and second order bends intra orally.

The double-sided head of the instrument has been specially designed to enable intra-oral steps to be created, even interproximally between lingual brackets where the space is very limited. For use up to max .018" x .018" wire (.46mm x .46mm)



BAND REMOVER

Cinch Back All-953

Improved Cinch Back The lower tip of the plier has been contoured to enable you to place the instrument closer to the distal end of the buccal tube. This results in a closer bend and improved patient comfort. The serrated tips of this instrument hold the wire securely while bending the wire 90° distal to the buccal tube. For use with Nickel Titanium wires .012" - .018" (.30 x .46mm).

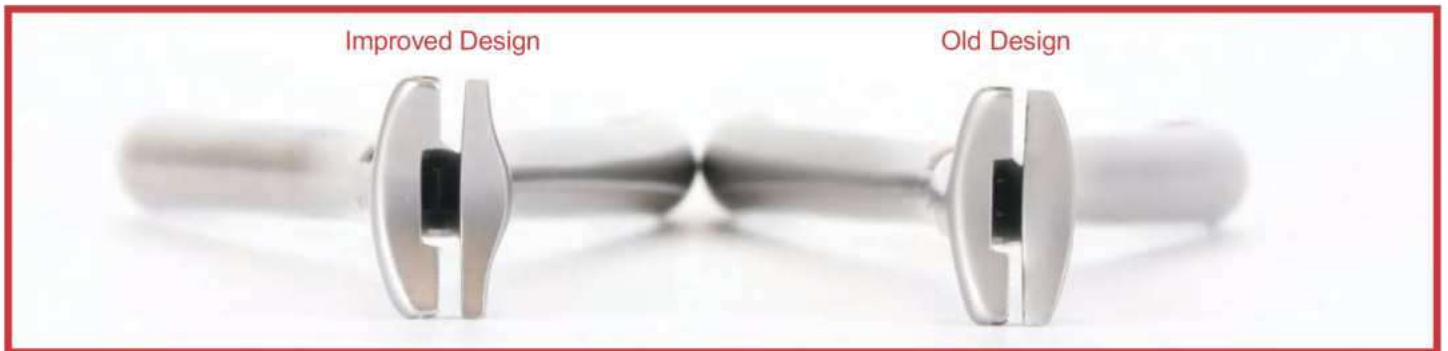

Cinch Back – Large Wire All-954

Same features as All-953 but designed to work with larger wires. The serrated tips of this instrument hold the wire securely while bending the wire 90° distally to the buccal tube, avoiding patient discomfort.

For use with wires from .016" (.41mm) up to .021" x .025" (.55 x .64mm).





M. E. P (MIRROR, EXPLORER, PINCETTE)

Bracket Holder



All-020

Tube Holder



All-021

Ligature Wire Holder



All-022

O-ring Holder



All-023

NiTi Coil Spring Holder

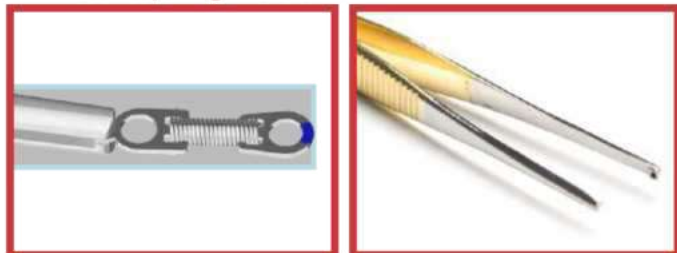

All-024



M. E. P (MIRROR, EXPLORER, PINCETTE)

Dental Explorer



All-025

Mini Explorer



All-026

Cotton Forcep



All-027

Mini Cotton Forcep



All-028

Dental Mirror



All-029

Mini Dental Mirror



All-030



Ligature Wire Tucker



All-031



archwire Tucker



All-032



Band Pusher



All-033



Forcep

Extracting Forcep-L (Lower)



All-034



Extracting Forcep-U (Upper)



All-035



Turret-S



All-036

Labial

- Torque Free
- Groove Diameter : .016
- .017
- .018
- .019
- .020
- .022

Turret-L



All-037

Labial Lingual

- Torque : 5 ~ 10°
- Groove Diameter : .016
- .017
- .018
- .020
- .022

Lingual Instrument Set

Turret-L

LT

AT

NTDP

LBR

AMPLC

HP

LUP

OH



POSITIONER

Mushroom Positioner Lingual



All-038

Horseshoe Positioner Labial



All-039



All-042

Positioner Stand



All-040

Set-Up Model Stand

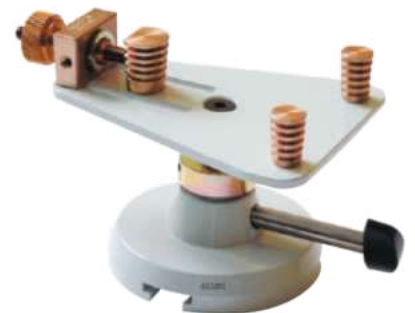

All-043

PROBE

Probe Single Ended
All-650



Probe Double Ended
All-651



Ligature Tucker
All-652



Mitchell Trimmer
All-653



Cement Spatula
All-656



Flat Plastic
All-657



Mirror Handle
All-654



Mirror Heads
All-655

Pk 12



LINGUAL TUCKER

All-945

The Allen Lingual tucker has been specially developed through consultation with experienced lingual orthodontists and is especially suited to use with self-ligating lingual brackets systems.

The Allen Lingual tucker gives optimum visibility and access during use in both the anterior and posterior region due to its unique design.



Direct Bond Bracket Holder All-850

Spring loaded reverse action holds brackets until release is desired. Positioning blade helps with final bracket slot alignment.



Direct Bond Holder with Positioning Blade All-630

Spring loaded reverse action holds brackets until release is desired. Positioning blade helps with final bracket slot alignment.



Deluxe Direct Bond Holder All-631

The Same high quality finish as All-850, with the addition of fine tips for easy placement of brackets and attachments. Positioning blade helps with bracket slot alignment.



TUBE HOLDER

Lingual Bracket and Bondable Tube Holder All-632

Reverse action Tube placer designed for placing bondable tubes and lingual brackets and attachments. Curved design Allows placement with an unobstructed view.



Curved Bracket Holder All-633

Designed for placement of Lingual brackets and attachments. Serrated tips give excellent grip.



Mershon Band Pusher All-845

Stainless steel serrated tip for positive control.



Mershon Band Pusher with small Round Handle All-846

The same tip as All-845, but with lower profile handle.



NEEDLE HOLDER

Mathieu Needle Holder with T.C. All-861

Sturdy, rounded tips designed for twisting ligature wire. Tungsten Carbide tips ensure durability.



Mathieu Needle Holder All-862

Sturdy, rounded tips designed for twisting ligature wire.



Smaha (Straight) All-863

Fine tips excellent for placing elastomeric ligatures.



NEEDLE HOLDER

Curved Mathieu Needle Holder with T.C. All-864

Sturdy rounded tips designed for twisting ligature wire. Curved Tungstall- Carbide tip provides easy access in difficult to reach areas and durability.



Fine Tip Mathieu Needle Holder All-860

Finer tips than the All-861.



Smaha Curved All-940

Fine curved tips but strong enough for inserting archwires and excellent for placing elastomerics to lingual brackets.



NEEDLE HOLDER

Curved Micro Mosquito All-941

Very Fine curved serrated tips and positive locking ensure consistent performance.

Used to place elastic ligatures in difficult to reach areas.



Mosquito Forceps All-855

Allen Mosquito Forceps have fine serrated tips.



Bracket Height Gauge .018 All-866

3.5mm-5mm - .018 For precise bracket positioning of .018 brackets.



Bracket Height Gauge .022 All-867

3.5mm-5mm - .022 For precise bracket positioning of .022 brackets.



Serrated Scissors All-870

Serrated tips are ideal for cutting stainless steel tape, bands and ligatures.



Aligner Scissors All-892

Scissors developed for using on Aligners and other thermo-formed materials.



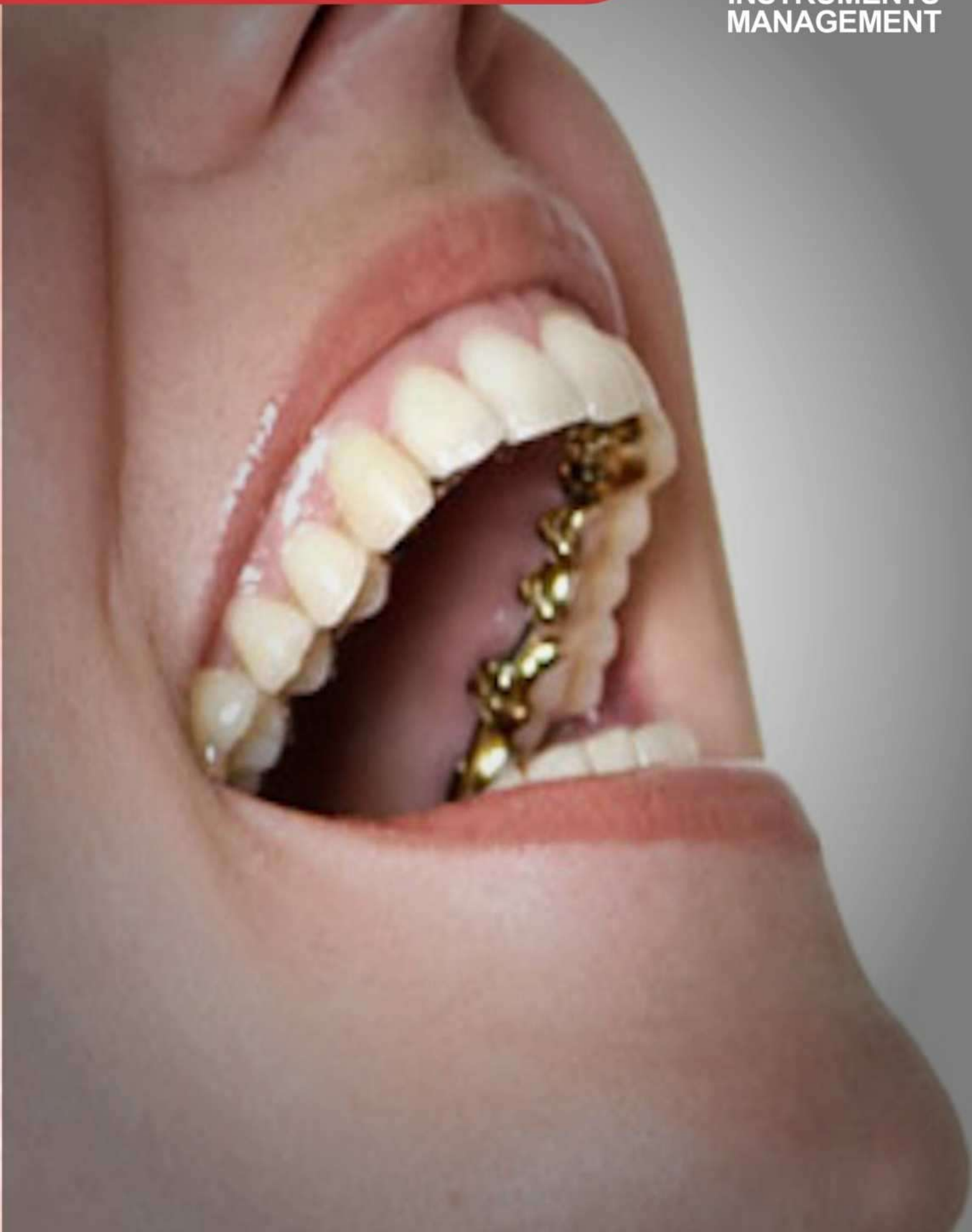

INSTRUMENTS MANAGEMENT



A. Combination Organiser

B. Covered Plier Organiser



C. Upright Plier Organiser



D. Round Plier Organiser

E. Plier Organiser



F. Combination Rack

Product	Size	Code
A.	6½" W x 3¾" H x 9¼" D	PDW#001
B.	7¼" W x 7½" H x 6" D	56146
C.	4¾" W x 5¼" H x 9" D White OT#IHW	
C.	4¾" W x 5¼" H x 9" D Black OT#IHB	
C.	4¾" W x 5¼" H x 9" D Clear OT#IHC	
D.	4" W x 4½" H	PDW#002
E.	14cm x 22.9cm	4150#501
F.	8.9cm x 17.8cm	4150#502
G.	15.5cm x 27cm	TOC#0601

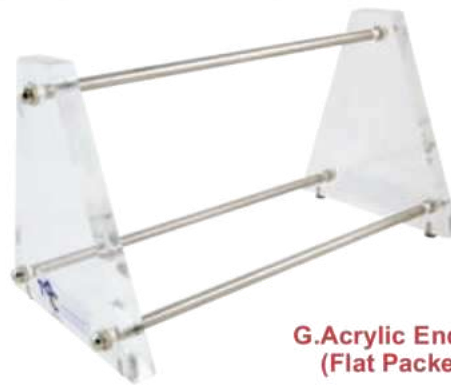

G. Acrylic Ended Plier Rack (Flat Packed)

Instrument Sterilisation Cassettes

A range of cassettes is available for easy handling of instruments. Made of stainless steel and silicone these trays are self locking and are the safest option for instrument logistics. Contact us with your requirements.



INSTRUMENTS MANAGEMENT

small Rack All-101

Autoclavable Stainless Steel Rack



Large Rack All-103

Autoclavable Stainless Steel Rack



Medium Rack All-102

Autoclavable Stainless Steel Rack





**Adams Plier with Inserted Tips
All-164**

Inserted tips have a high resistance to deformation or wear under consistent use, providing continued accuracy and precision during appliance construction.

Bends hard wire up to .039" (1.00mm) max.

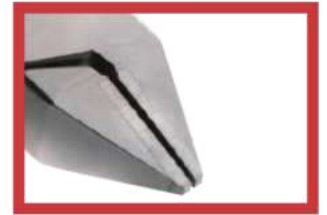

**Spring Former Plier with Inserted Tips
All-165**

Tungsten Carbide inserted tips. Perfectly machined to produce accurate coil springs.

Bends hard wire up to 0.28" (0.7mm) max.



**Universal General Use Plier
All-700**

Both Tips are serrated. Bends hardwire up to .039" (1.0mm) max. Cuts hardwire up to .028" (0.7mm) max.



**Three Jaw Plier
All-701**

Can be used to bend the arms of rapid expansion screws.

For hard wire up to 0.59" (1.5mm) max.



**Three Jaw Plier
All-702**

For hard wire up to .024" (1mm) max.



**Young Plier
All-703**

For labial arches and canine loops. For hard wire up to .028" (0.7mm) max.



**Swartz Plier
All-704**

Arrow clasp forming plier. For hard wire up to .028" (0.7mm.) max.



**Lingual Arch Universal Plier
All-705**

Grooved to hold All larger wire sizes, jaw width is .120" (3.05mm). Also ideal for double and triple back bends.

Bends round, square and rectangular wires up to .036" (0.91mm) max.



**Flat Nose Plier
All-706**

Both Tips serrated. For use with wire up to .036" (0.9mm) max.



Conical Flat Nose Plier All-707

Has one serrated and one smooth tip.
For use with wire up to .028" (0.7mm.) max.



Optical Plier All-708

For hardwire up to .028" (0.7mm) max.



Flat Nose Plier All-710

A favourite general purpose plier - both tips of this flat nose plier are serrated with a guiding groove for use by the technician or clinician for chairside adjustments of wire up to .028" (0.7mm).



**Heavy Duty Bird Beak Plier
with T.C. Inserts
All-711**

This plier is ideal for the fabrication of labial and lingual arches, quad helAll-, and many other appliances.

This heavy duty bird beak plier has special inserted tips which Allows the bending of wire up to .040" 1mm.



**All-712
Heavy Duty Hard Wire Cutter**

This plier is ideal for cutting labial and lingual arches, quad helAll-, and many other appliances.

Double spring design Allows for easy cutting of hard wire up to .060" (1.5mm).



TOOTH AUTOTRANSPLANTATION

Transplantation sAll-t Kit All-200

Tooth auto transplantation is the surgical movement of a donor tooth to a recipient site within the same individual. Autotransplantation is essentially a controlled avulsion and replantation, either into an extraction site or a surgically-prepared artificial socket.

Premolar transplantation is a well-recognised technique for managing missing anterior teeth, including teeth lost through trauma or developmentally absent teeth, such as in hypodontia and cleft palate. Other indications include replacement of a failing or a poor-prognosis permanent tooth and surgical repositioning of an impacted or ectopic permanent tooth.

ALLEN Orthodontics has developed a range of transplantation sAll-ts with The Leeds Dental Institute autologous transplantation team.



Kit includes 3 x sAll-ts - small, medium and large - plus stainless steel sterilisation cassette including locking arm (not shown).

The set of sAll-ts have been produced to:

- Minimise extra-oral time of the donor tooth/teeth.
- Reduce the damage to the periodontal ligament of donor tooth by minimising the number of try in attempts when assessing the donor tooth's fit in the recipient site.
- Provide flexibility to the surgeon by providing a variety of sAll-t sizes, thereby allowing them to choose the most appropriate premolar to transplant.